

Location:



**FRP**

## 2 1/2" THRU 10" REDUCED PRESSURE ZONE BACKFLOW ASSEMBLIES

**Specification:** The BEECO Friendly Reduced Pressure Zone Backflow Preventer Valve is designed to stop the reverse of flow of a liquid into a potable water system. The proper installation of a backflow preventer must be done by a certified expert under local codes and guidelines to assure the protection of the drinking water system. The Valve shall be certified to ASSE 1013. Is Certified to cUPC and IAPMO listed. Certified lead free devices.

**Function:** The assembly shall consist of two repairable positive seating check modules with captured springs and rubber seat discs. Service of all internal components shall be through a single easily removable cover and designed for ease of access. The valve shall have a relief valve to atmosphere.

**Features:** Single access cover for fast service, Swing away clamp for ease of removing checks, Modular design reducing number of spare parts, Self contained check so there is no pressure to relieve when changing the seats. The relief valve like the checks are easily repairable in line and is positioned for maximum protection in the vertical up position.

**Ratings:** Maximum working water pressure 175 PSI, Working temperature range 33°F-140°F. Hydrostatic test pressure 350 PSI, Flanged end connection meet ANSI B16.1 and all grooved dimensions comply with AWWA C606.

Complies with AWWA-C511

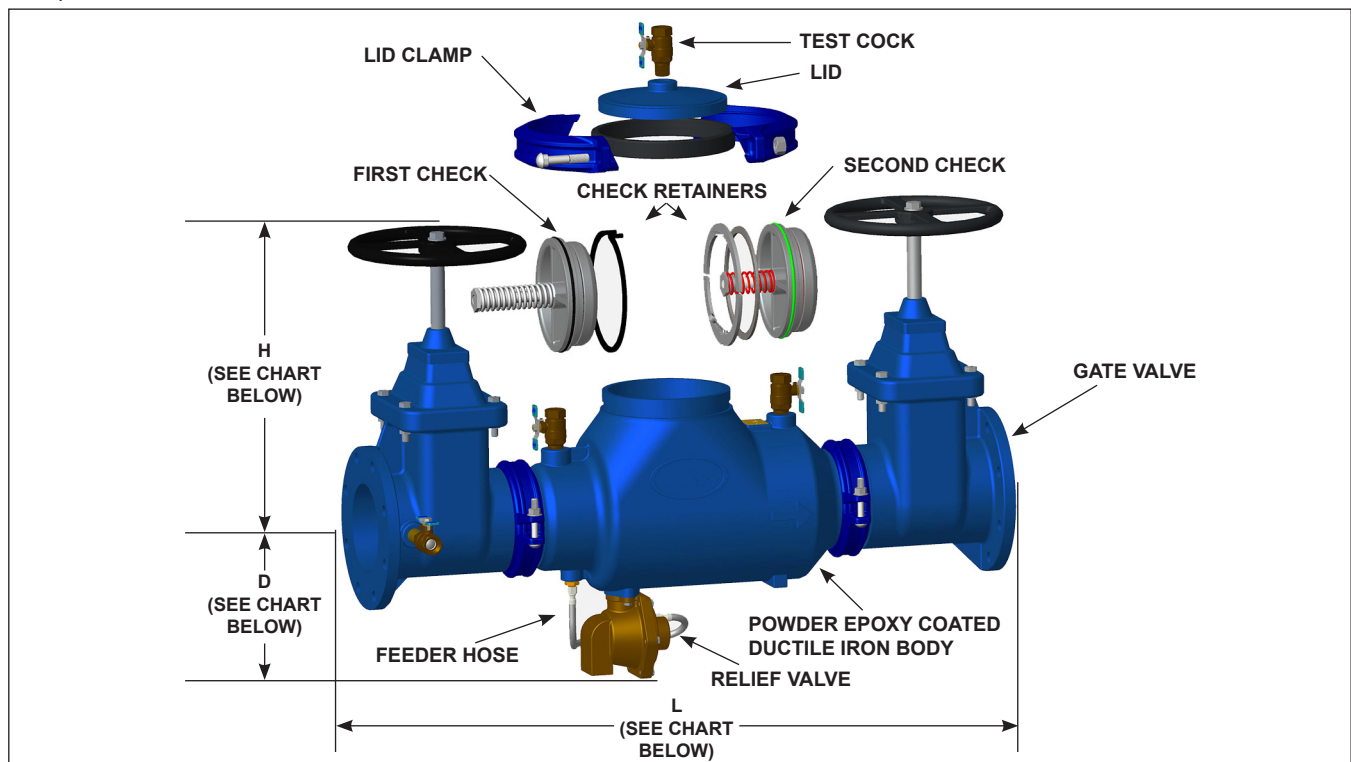
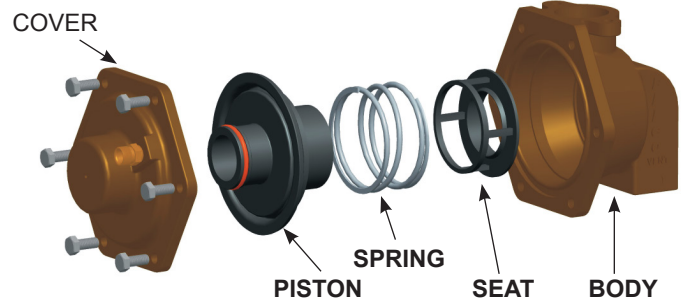

All RP devices must be installed where a drain is available to cover the discharge in event there is a backflow condition and the relief valve discharges. Discharge rates are as follows: 1/2" to 1" 5 GPM, 1 1/4" to 2" 20 GPM, 2 1/2" to 6" 20 GPM, and 8" to 10" 60 GPM.

Model No.	Size	L	H OSY Open	H NRS	D	Flange Bolt Torque (ft.-lbs.)
FRP2.50	2 1/2"	33.5	18.88	16.38	9.75	70
FRP3.00	3"	34.5	21.88	18.88	9.75	70
FRP4.00	4"	40.8	25.63	21.63	9.75	75
FRP6.00	6"	43.8	35.13	29.13	11.25	130
FRP8.00	8"	56.5	44.63	36.63	15.75	130
FRP10.00	10"	59.5	54.5	44.5	15.75	180

### SUFFIX OPTIONAL VARIATIONS

<input type="checkbox"/> -NRS	Non Rising Stem Gate Valve
<input type="checkbox"/> -OSY	Outside Stem and Yoke Gate Valve
<input type="checkbox"/> -BA	Meets Buy America and Pennsylvania Steel Act
<input type="checkbox"/> -S	Strainer Attached
<input type="checkbox"/> -DCDA	Double Check Detector Assembly
<input type="checkbox"/> -G	Grooved Flange Connection
<input type="checkbox"/> -LF	No Gate Valves

Job Name:   
 Section No:   
 Schedule No:

Page No:   
 Contract:   
 Purchase Order No:

Location:



**FRP**

**2 1/2" THRU 10" REDUCED PRESSURE  
ZONE BACKFLOW ASSEMBLIES**

**\*Valves Approved for Horizontal or Vertical Up Orientation.**

