

Series 800M3

Pressure Vacuum Breaker

Sizes 1/2" and 3/4"

Repair Kits

When ordering specify Ordering Code, Kit No., and Valve Size.

ORDERING CODE	KIT NO.	SIZE	LIST PRICE
---------------	---------	------	------------

Check Kits

LEAD FREE	0886042	RK 800M3 CK	1/2", 3/4"	\$27.25
-----------	---------	-------------	------------	---------

Kit consists of: check disc assembly (disc & disc holder), bonnet O-ring and check spring.

Vent Float Kits

LEAD FREE	0886041	RK 800M3 V	1/2", 3/4"	13.25
-----------	---------	------------	------------	-------

Kit consists of: float vent disc assembly (vent float, seal & spring) and bonnet O-ring.

Bonnet Assembly Kits

LEAD FREE	0886040	RK 800M3 B	1/2", 3/4"	41.00
-----------	---------	------------	------------	-------

Kit consists of: bonnet, bonnet O-ring, vent spring, hood & hood screws.

Rubber Part Kits

LEAD FREE	0886039	RK 800M3 RT	1/2", 3/4"	18.25
-----------	---------	-------------	------------	-------

Kit consists of: vent seal, check disc and bonnet O-ring.

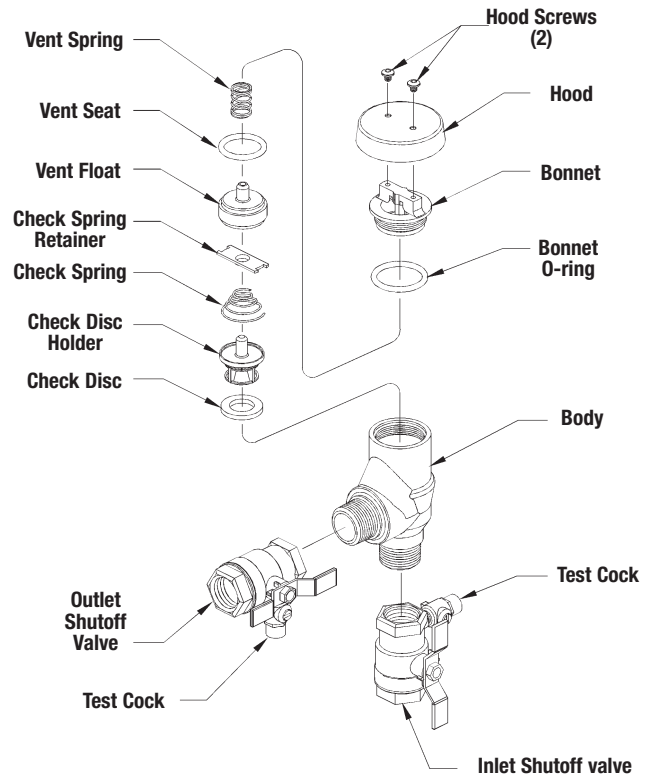

Series 800M2

Pressure Vacuum Breaker

Sizes 1/2" – 2"

Repair Kits

When ordering specify Ordering Code, Kit No., and Valve Size.

ORDERING CODE	KIT NO.	SIZE	LIST PRICE
---------------	---------	------	------------

Check Kits

LEAD FREE	0886037	RK 800M2 CK	1/2" – 1"	\$27.25
	0886038	RK 800M2 CK	1 1/4" – 2"	48.25

Kit consists of: check disc assembly (disc & holder), bonnet O-ring and check spring.

Vent Float Kits

LEAD FREE	0886035	RK 800M2 V	1/2" – 1"	13.25
	0886036	RK 800M2 V	1 1/4" – 2"	31.50

Kit consists of: float vent disc assembly (vent float, seal & spring) and bonnet O-ring.

Bonnet Assembly Kits

LEAD FREE	0886033	RK 800M2 B	1/2" – 1"	41.00
	0886034	RK 800M2 B	1 1/4" – 2"	90.25

Kit consists of: bonnet, bonnet O-ring, vent spring, hood & hood screws.

Rubber Parts Kits

LEAD FREE	0886031	RK 800M2 RT	1/2" – 1"	19.00
	0886032	RK 800M2 RT	1 1/4" – 2"	26.75

Kit consists of: vent seal, check disc and bonnet O-ring.

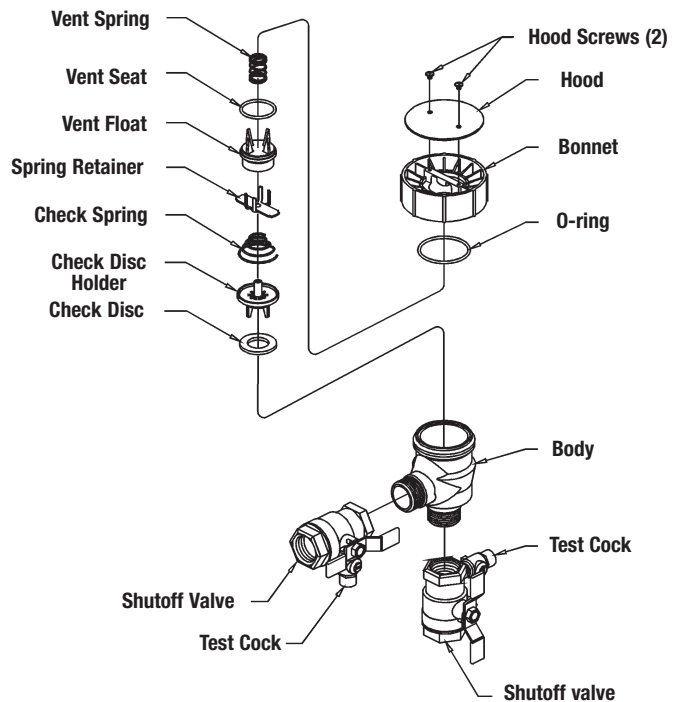

*The wetted surface of this product contacted by consumable water contains less than 0.25% of lead by weight.